

Grandview[®]

Instruction Manual

X – Arm Projector Lift

Models
GPSC-5005B
GPSC-5010B
GPSC-5015B

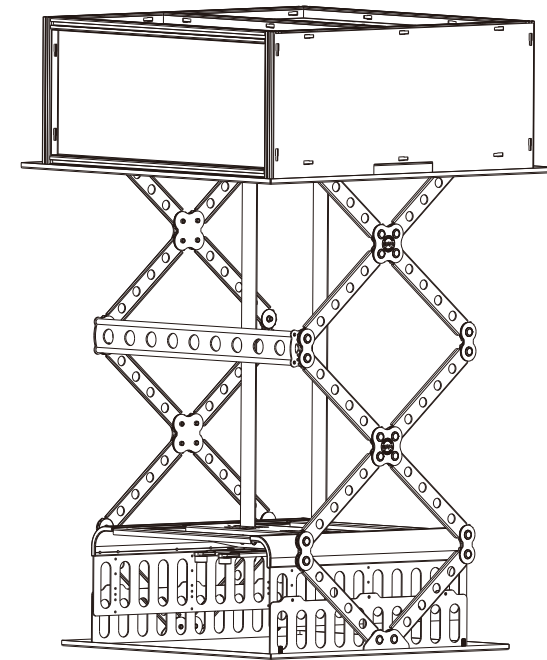

Grandview[®]

Guangzhou Grandview Creative Technology Co., Ltd
Add: No.1 Building of No.43 South International Trade Avenue,
Hualong Town, Panyu District, Guangzhou China.
Tel: +8620-8489-9499 Fax: +8620-8480-5299
[Http://www.grandviewscreen.com](http://www.grandviewscreen.com)



Grandview[®]

Thank you for purchasing this product. Before use, please ensure that the mounting bracket is suitable for your projector equipment and read this manual carefully.

Important safety instructions

WARNING: To reduce the risk of fire or electric shock, do not expose product to rain or moisture.

- Please read this manual before installation and use to avoid damage to the product due to improper installation and use.
- Keep away from heat sources such as radiators, heaters, stoves and other equipment (including amplifiers).
- Only connect power plugs with grounded conductors.
- Only use accessories provided by the supplier.
- If you encounter lightning storms or if the product is not used for a long time, please unplug the power cord.
- Please leave it to professional service personnel for installation and maintenance.
- Never install the product in a humid or location where water may be splashed.
- This unit is not disconnected from AC power as long as the product plug is connected to the power source.
- Please use a power cord (3-core wire/device/connector/plug) that meets specific voltage and current ratings. If you have any questions about its use, consult professional maintenance personnel.
- Please use an approved power cord (3-core power cord)/device interface/plug, and its grounding plug should comply with applicable national safety regulations.
- When installing this equipment, provide an easily accessible disconnect device in the fixed wiring, or connect the mains plug to an electrical outlet that is close to the equipment and easily accessible. If a malfunction occurs while operating the device, the device can be disconnected by cutting power to the de-energized device power supply, or disconnect the power plug.
- The installation location must have sufficient mechanical strength, and the load-bearing requirement is 4 times the weight of the projector lift. Otherwise, an accident may occur or the lift may fall off.
- The ceiling cutting height must be greater than the product height; otherwise, it cannot be installed properly. Please ensure the ceiling installation height exceeds the product height by at least 100mm.



Note:

Objects other than projectors cannot be mounted.



Disassembly prohibited:

Do not disassemble or dismantle the components of the mounting bracket!

This installation and operation manual is written for dealers and installation technicians. Customers are advised not to install it by themselves. They must hire qualified professional technicians to install and follow the installation instructions.

AI Speaker Connection Method

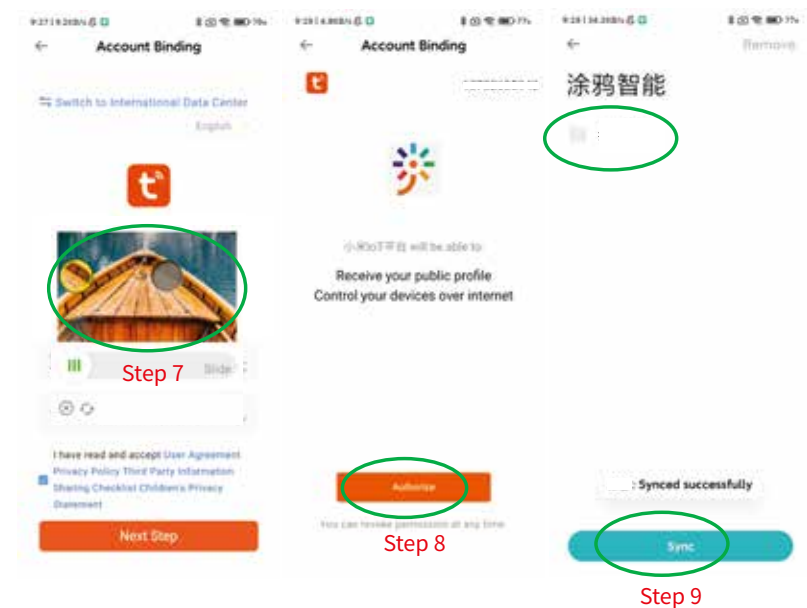

Troubleshooting

The projector lift is designed for years of trouble-free use, with most problems stemming from simple issues. If you find an issue, check out the list of simple fixes below.

	Reasons	Solutions
Lift stand fully installed but not functioning properly	The positive and negative poles of the transmitter battery are reversed or the battery power is insufficient.	Refer to the instruction manual to check whether the battery is installed backwards. If the fault is not eliminated, replace the battery.
	The power cord is not connected properly	Refer to the instruction manual to connect the power cord and plug it in tightly.
Remote control does not respond	Poor reception/blocked signal	Restart the lift power
Restart the lift power	The rear signal line is blocked	Deal with the wire direction/adjust the lift position

AI Speaker Connection Method

Supports AI speakers like Xiaomi XiaoAI, Xiaodu, Tmall Genie, etc. Using Xiaomi XiaoAI speaker as an example:

- 1. Open the Mi Home APP and click 'Profile' in the bottom right corner.
- 2. Click 'Connect to other platforms' and add 'Tuya Smart'.
- 3. Bind your account: - Enter your phone number (Tuya account) and proceed. - Verify your account. - Enter your Tuya account password and proceed. - Authorize the connection.
- 4. Sync devices. Binding is now complete.

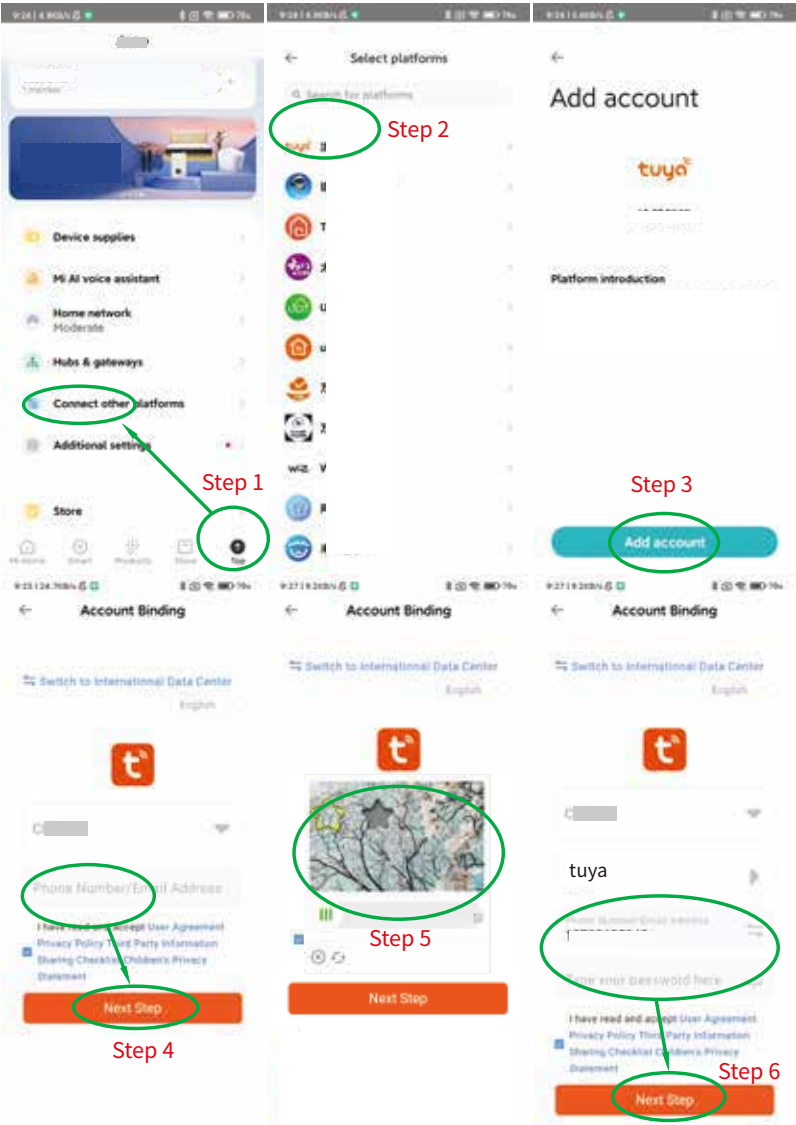

Parts

GPSC-5010B Ultra-Thin Motorized Projector Lift

- ①-Outer Frame
- ②-Decorative Frame
- ③-Scissor Arm
- ④-Projector Mount
- ⑤-Motor Components
- ⑥-Power Cloth Belt
- ⑦-Decorative Base Plate

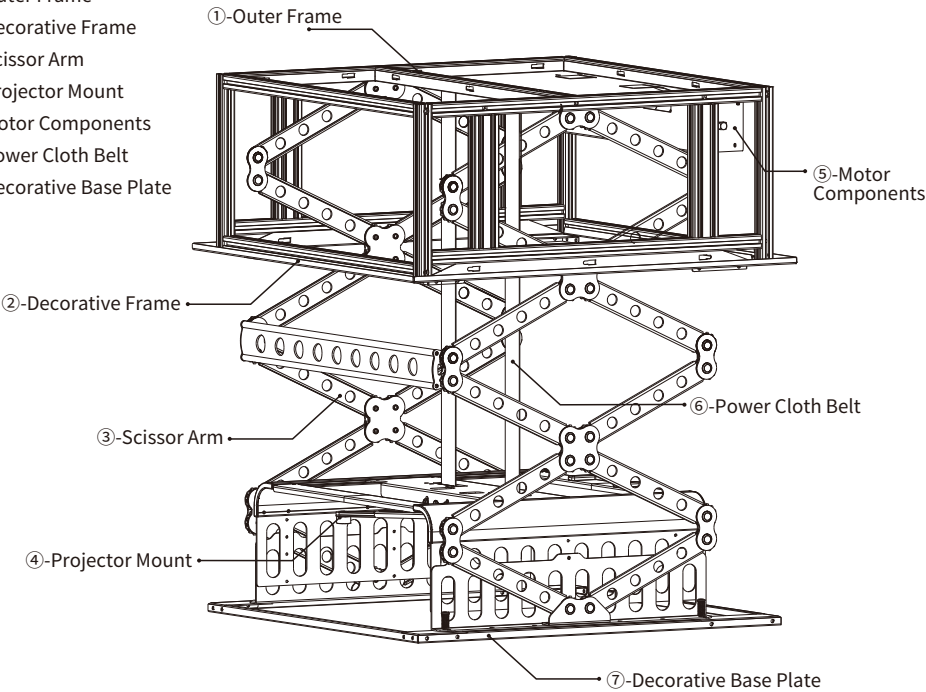

Accessories

- | | | | | |
|-------------------------------|------------------------|-------------------------------|------------------------------|--------------------------|
| (1) | (2) | (3) | (4) | (5) |
| (1) Allen Key 1pc | (2) Remote Control 1pc | (3-1) M5x30 Socket Screw 4pcs | (4) M8 Expansion Anchor 4pcs | (5) Mounting Spacer 4pcs |
| (3-2) M4x30 Socket Screw 4pcs | | (3-3) M5x20 Socket Screw 4pcs | Instruction Manual 1pc | |
| (3-4) M4x20 Socket Screw 4pcs | | | | |

Installation

Installation instructions

This product is suitable for installation in various suspended ceilings. This manual takes the installation method of the grille ceiling as an example. Please adapt the installation method to suit different environments. This product should be installed in the best projection position. Correct installation will make the product more convenient and safer during use. Open the packaging box, check whether the spare parts are complete, then take them out and put them in a suitable place for installation according to the following operation methods.

* For the safety and convenience of the lift, please read the entire installation section of the instruction manual and choose the most suitable installation method according to your actual site conditions!

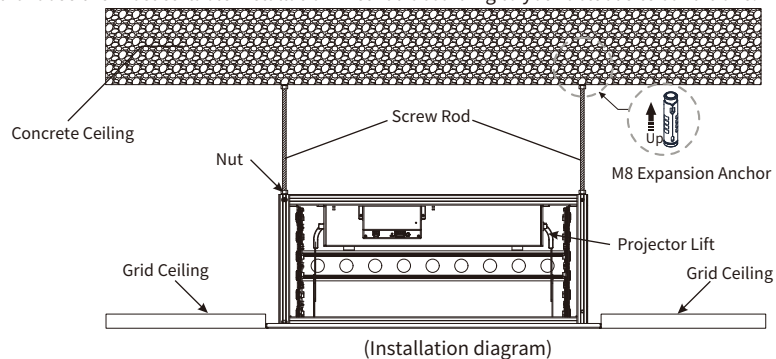

Parameters

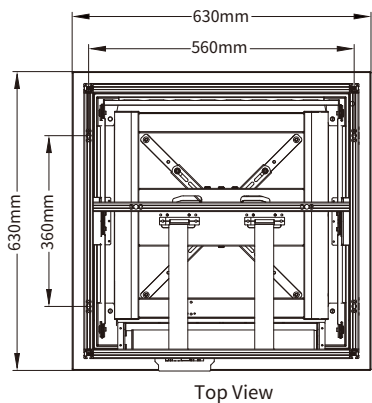
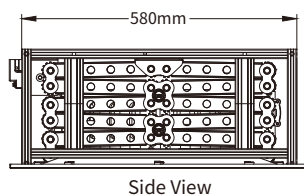
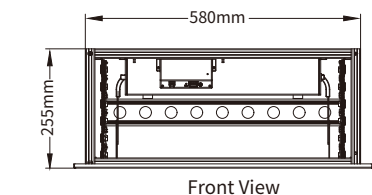

Product Parameters:

Model: GPSC-5010B

Product Dimensions: W580 x D580 x H255 mm

Max Projector Size (with plug and lens): W440 x D480 x H180 mm

Ceiling Opening Dimensions: W600 x D600 mm

Installation hole distance: W560 x D360 mm

Decorative Base Plate: W630 x D630 mm

Rated power: 145W

Max Travel: 1000 mm

Weight capacity: 12Kg

Rated voltage: AC110~120V / 60Hz or AC220V~240V / 50Hz

(Actual voltage shall be subject to the electrical label shown on the product)

Wi-Fi Network Control

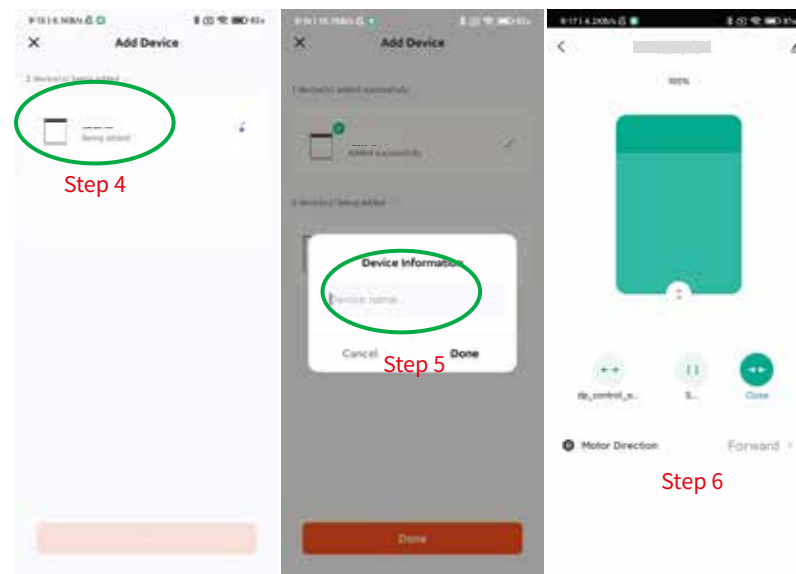

Wi-Fi Network Control

Tuya Smart APP Wi-Fi Configuration

If the product has already been connected to a network but needs to connect to a new network or new phone, it must first be cleared.

a. Clearing Network Using the Bracket Remote Controller:

- 1. Press the button on the back of the remote control. The light will turn on, and the bracket's mainboard will beep once and vibrate to enter setup mode.
- 2. Then, press the 'Stop' button on the remote control for 5 seconds. The bracket will vibrate, and the mainboard will beep twice ('beep beep'). Clearing is complete.

b. Connecting to the Network:

- 1. Ensure your phone is connected to a 2.4G Wi-Fi network and Bluetooth is enabled.
- 2. Open the Tuya Smart APP, click the '+' icon to add a device, and select the discovered device to add.
- 3. Enter the 2.4G Wi-Fi password, modify the device name (optional), and complete the addition.
- 4. A control interface will pop up, and setup is complete.

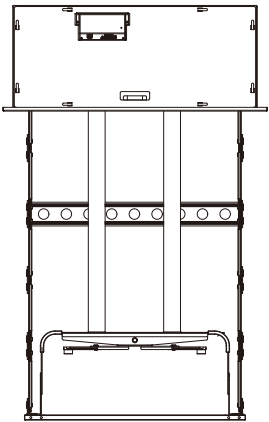
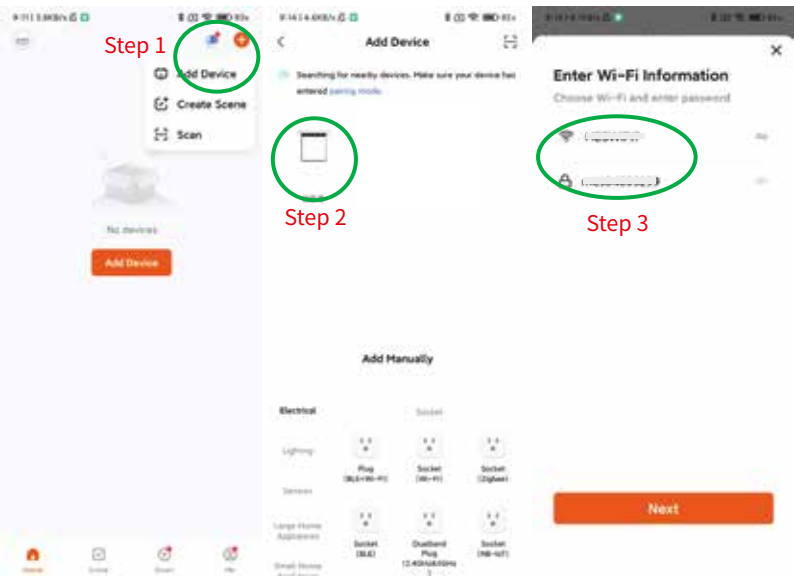

(Maximum height map)

Table 1 Unit: mm

Model	Name	Travel height range	Maximum load bearing capacity(KG)
GPSC-5005B	Single X node	500	15
GPSC-5010B	Double X node	1000	12
GPSC-5015B	Triple X node	1500	10

Flush Installation: The projector's decorative base plate is flush with the ceiling
Cover Installation: The decorative base plate of the projector just covers the ceiling
Maximum projector installation size:W440xD480xH180mm

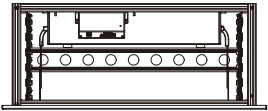

(Minimum height map)

Refer to the figure and table for the model-specific dimensions needed to determine the ceiling opening size for your projector lift. If the ceiling is higher than the minimum height, please secure it with screws. If the ceiling is lower than the minimum height, it is recommended that the ceiling opening size be larger than the reference value. Finally, the user chooses the installation method based on the actual situation. (Refer to the lifting frame model: Table-1. Note that the ceiling opening must ensure that the projector lift is not blocked.)

Ceiling opening size
For cover installation: 600 mm x600 mm
For flush installation: 640 mm x 640 mm

Installation Steps

- 1.Determine the direction of the projector and the installation position,according to the size of the opening in the ceiling layer.

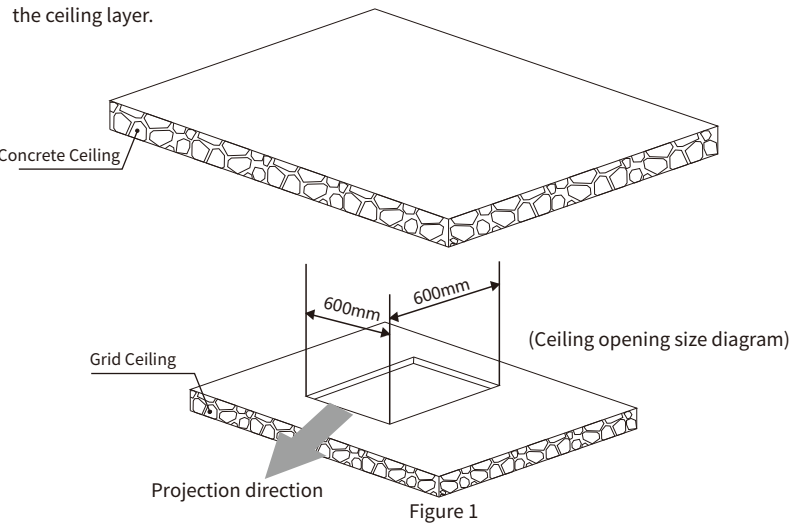

Installation Steps

2.Punching the concrete base and install the M8 Expansion Anchor.

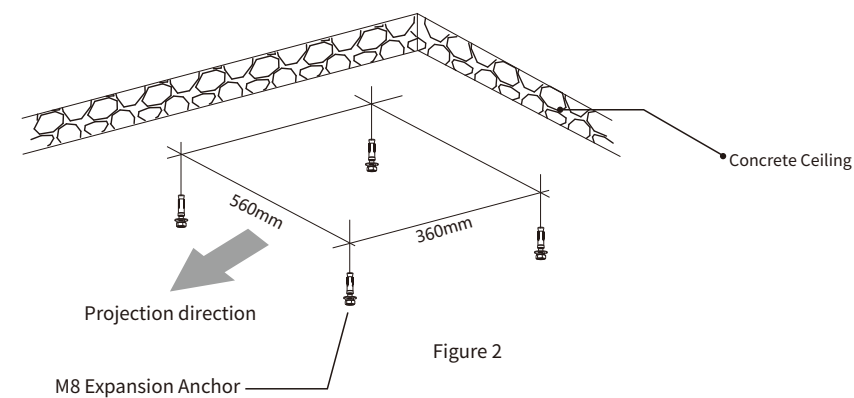

3.After ensuring that the tapping screw is securely fixed, install and fix the screw rod. To facilitate insertion through the lifter, we recommend tapering the end of the screw rod. The length between two consecutive screw rods can vary by 10-20mm.

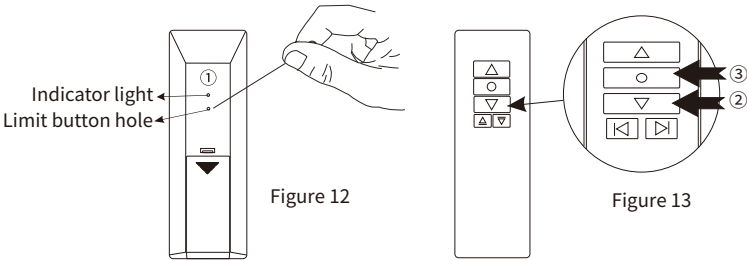
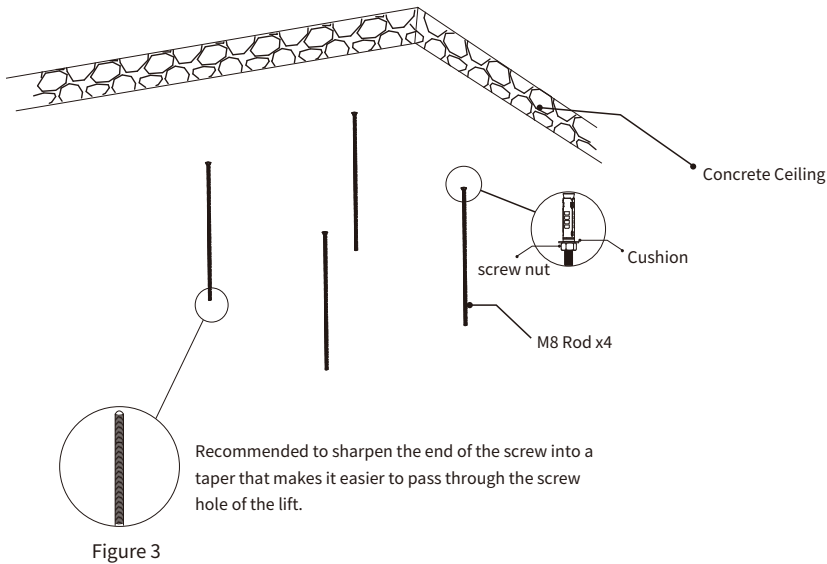

RS-485 Protocol

1.RS-485 port settings

- a.Baud rate:2400
- b.Data length:8
- c. Parity check:N
- d.Start bi: 1
- e.Stop bit:1

2.Control code

- a.Rise command:FF EE EE EE DD
- b.Stop command:FF EE EE EE CC
- c.Descending command:FF EE EE EE EE

Learn address code instruction:
if FF--- AA, Can be any character or number, If input FF 11 11 11 AA,It is FF 11 11 11 DD actually,
Other codes do the same.

Notice:

- 1.When connecting via RS485, if any control fails, please switch two controlling cables.
- 2.The resistance measured by a Loop Resistance Tester should not exceed 20Ω.
- 3.Prohibit parallel line with strong interference source.

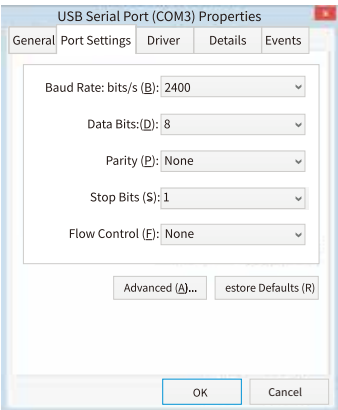

Remote Controller Pairing and Clearing Methods

Remote Controller Pairing Method:
(Factory-paired, no need for re-pairing)

Method 1:

1. Turn off the power of the electric bracket and then turn it back on.
2. Within 10 seconds, press the 'Up' and 'Stop' buttons on the remote control simultaneously.
3. The electric bracket will slightly move up and down, indicating successful pairing.

Method 2:

1. With the electric bracket powered on, press the 'Learn' button on the mainboard with a pin.
2. The bracket enters pairing mode. Press the 'Up' and 'Stop' buttons on the remote control simultaneously.
3. The bracket will move slightly up and down, indicating successful pairing.

Remote Controller Clearing Method:

To clear the pairing, perform the pairing procedure again with the already paired remote controller.

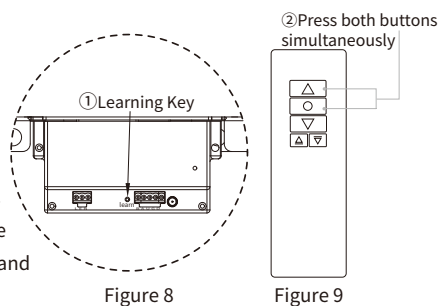

Remote control electronic positioning

- a. When the lift is under load, you can use the remote control to set the upper and lower limits of the lift according to the needs of the site.
- b. Use a small paper clip or small round needle to insert the electronic positioning setting key hole of the elevator on the back of the remote control (as shown in figure 10), press the electronic positioning setting button of the elevator, the red and blue LEDs will light up, and then press the elevator Rack up button, at this time, after the lift rises to a suitable position, press the stop button of the remote control (as shown in Figure 11), and then press the up button electronic positioning setting button, the red and blue light-emitting diodes are off, and the lift moves up and down. Once, the electronic upper limit setting of the lifting frame is completed.

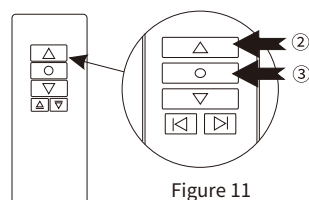
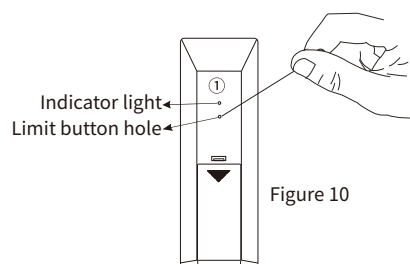

- c. Use a small paper clip or small round needle to insert the electronic positioning setting key hole of the elevator on the back of the remote control (as shown in figure 12), press the electronic positioning setting key of the elevator, the red and blue LEDs will light up, and then press the elevator Rack down button, at this time, after the lifting frame is lowered to a suitable position, press the stop button of the remote control as shown in figure 13), and then press the electronic positioning setting button of the lifting button, the red and blue light-emitting diodes are off, and the lifting frame moves up and down. The electronic lower limit setting of the lifting frame is completed.

Installation Steps

4. Align the product holes with the screw rods, carefully insert the screw rods so that they penetrate the product, fit the gaskets and anti-slip nuts and tighten them to secure the suspension. Finally, install the decorative base plate to complete the installation.

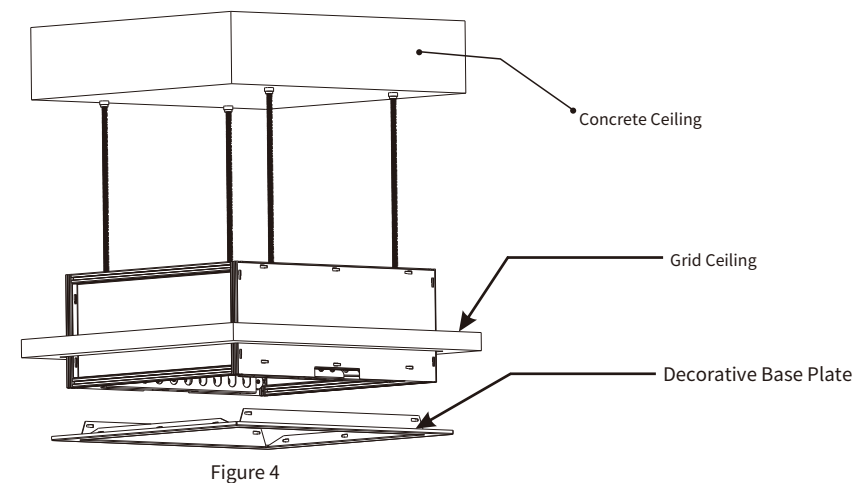

Projector Orientation

1. Secure the mount legs onto the projector, ensuring that the projector's orientation aligns with that of the lift. You can use an Allen key to loosen the screws on the mount legs and adjust their length for installation. After mounting the projector onto the lift, hold it upwards to allow the lift's rivet to snap into the universal joint (as shown in Figure 5). Once the projector's projection angle is adjusted, tighten the screws on both sides of the universal joint to secure it.

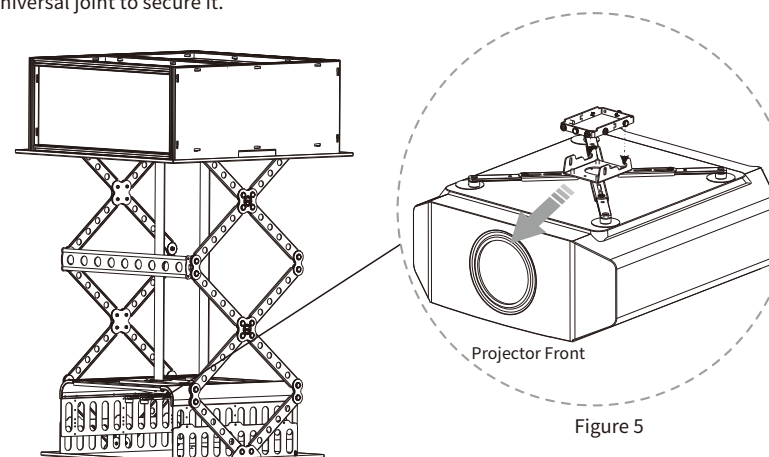

Projector Orientation

2.To adjust the projector's height, loosen the screws on the fixing plate for the power cloth belt, pull the belt, and adjust the descent between 0mm and 1000mm.

For larger projectors, loosen the fixed screws on the cage, adjust to the desired height, and secure by tightening the screws in the new positions.

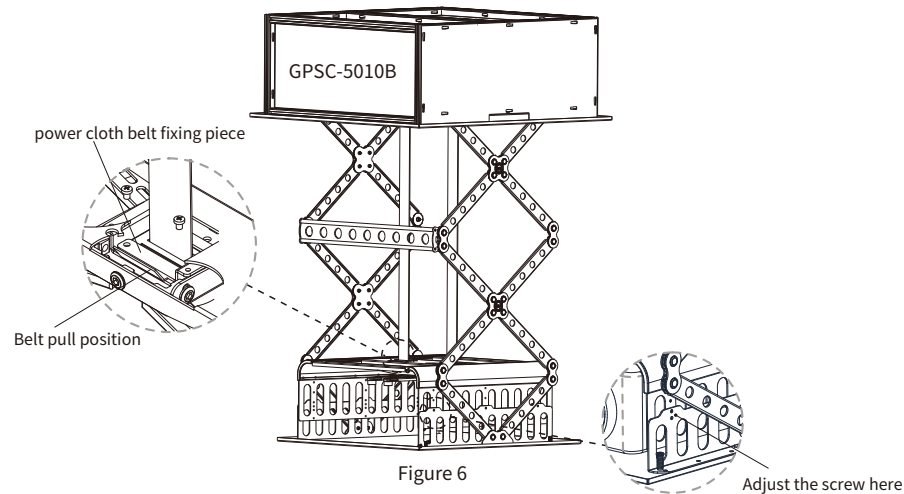

Projector Angle Adjustment

Vertical Adjustment of the Projector

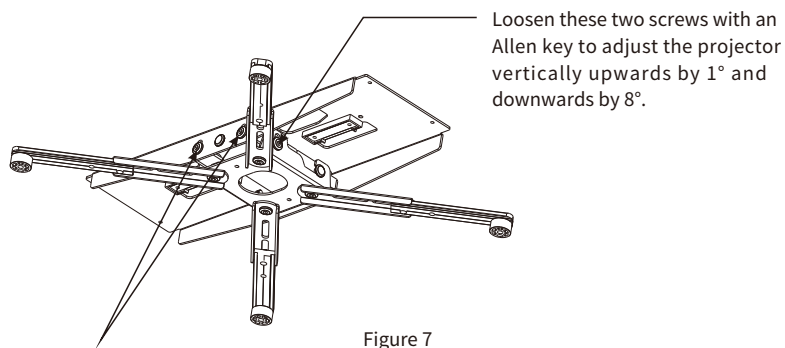

Horizontal Angle Adjustment of the Projector

Loosen these two screws with an Allen key to rotate the projector horizontally left and right by 4°.

Electrical and Installation Instructions

Connect the power cable and signal cable, as shown in Figure 8

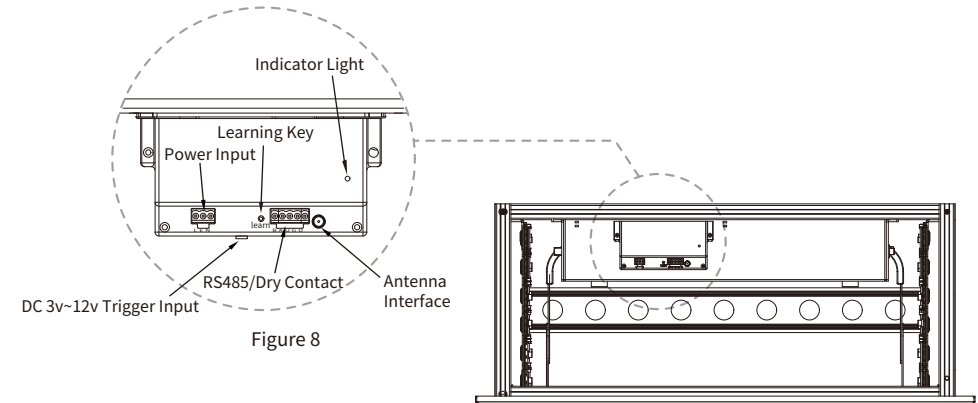

L: Live wire, E: Ground wire, N: Neutral wire

φ2.5 interface: DC 3v~12v trigger input

B: RS-485-, A: RS-485+

U: Up, G: public, D: Down

When the 'G' (ground) and 'U' (up) wires are connected, the lift will rise.

Touch G and D once and the lift will descend.

Remote Functions Guide

Remote Functions

1. Press the up button and the projector lift will rise.
2. Press the stop button to stop the projector lift.
3. Press the button to lower the projector lift.

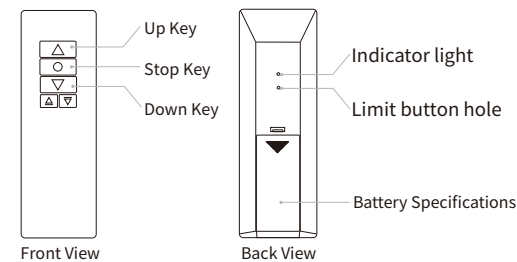

Precautions when using remote control

1. Working temperature: -20°C to ±70°C.
2. Transmitter battery: Two AAA 1.5V batteries.
3. When the signal from the remote control is weak, please replace the battery.

Remote control battery replacement and installation
When the signal from the remote control is weak, please replace the battery as follows:

1. Push the back cover of the remote control downward to remove it.
2. Install new batteries, ensuring correct polarity (+/-).
3. Replace the back cover. Battery replacement is complete.